

Stonecross Meadows

The Richmond B – 3 bedroom semi-detached home

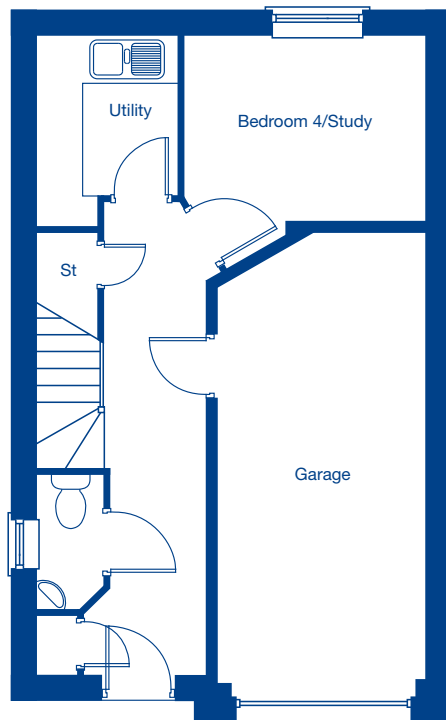



Ground Floor

Bedroom 4/Study	3.15m x 2.51m	10'4" x 8'3"
Utility	2.56m x 1.85m	8'5" x 6'1"
Garage	6.15m x 2.72m	20'3" x 8'11"

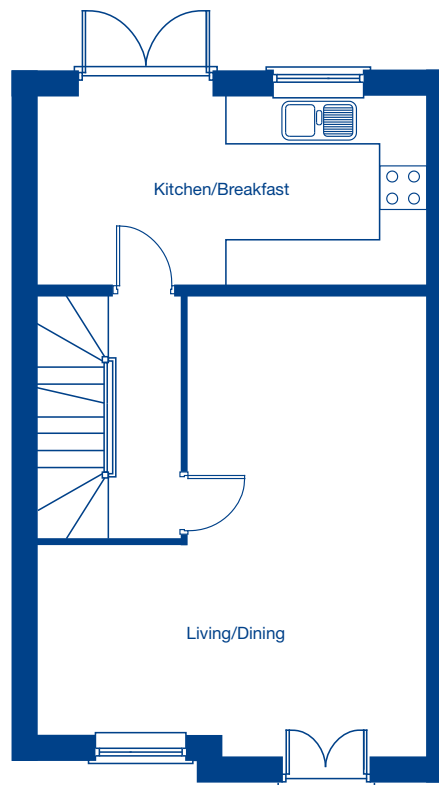

First Floor

Living/Dining	6.33m x 5.09m	20'9" x 16'8"
Kitchen/Breakfast	5.09m x 2.56m	16'8" x 8'5"

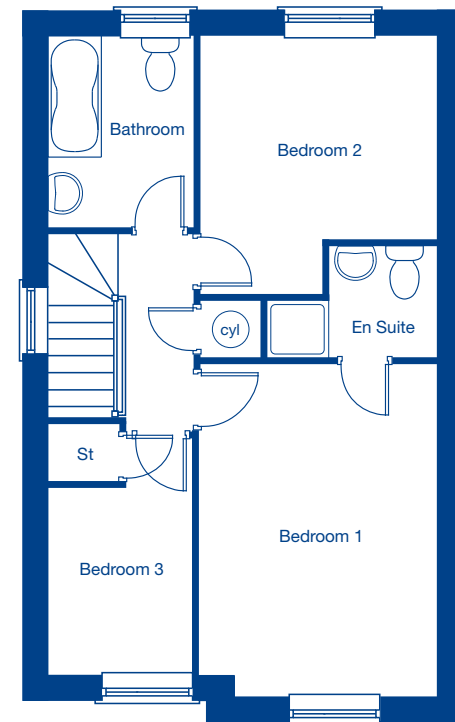

Second Floor

Bedroom 1	4.59m x 3.09m	15'1" x 10'2"
Bedroom 2	3.51m x 3.09m	11'6" x 10'2"
Bedroom 3	3.27m x 1.91m	10'9" x 6'3"

Please refer to floor plans for orientation of the property

These floor plans and images are for guidance and illustrative purposes only and do not form part of any contract. All room sizes are approximate to maximum dimensions and some plots may be subject to additional gable or bay windows. Please ask our Sales Advisor for details on specification and plot specific street scenes. Every effort has been taken to ensure these plans are as accurate as possible at time of printing. However, Jones Homes reserves the right to vary details as may be necessary and without notice. JHL3322/June 2019.