

Kingsfield Park

The Styal – 4 bedroom detached home

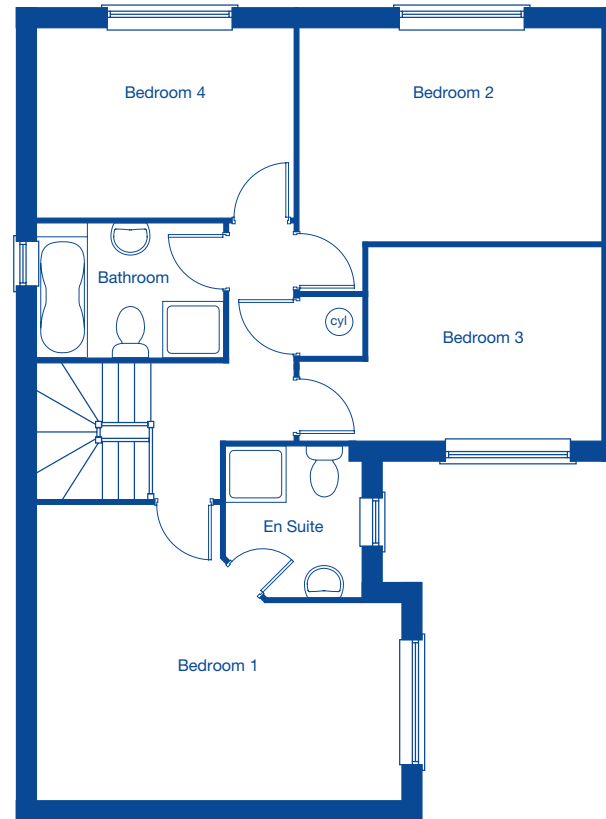

JONES
HOMES

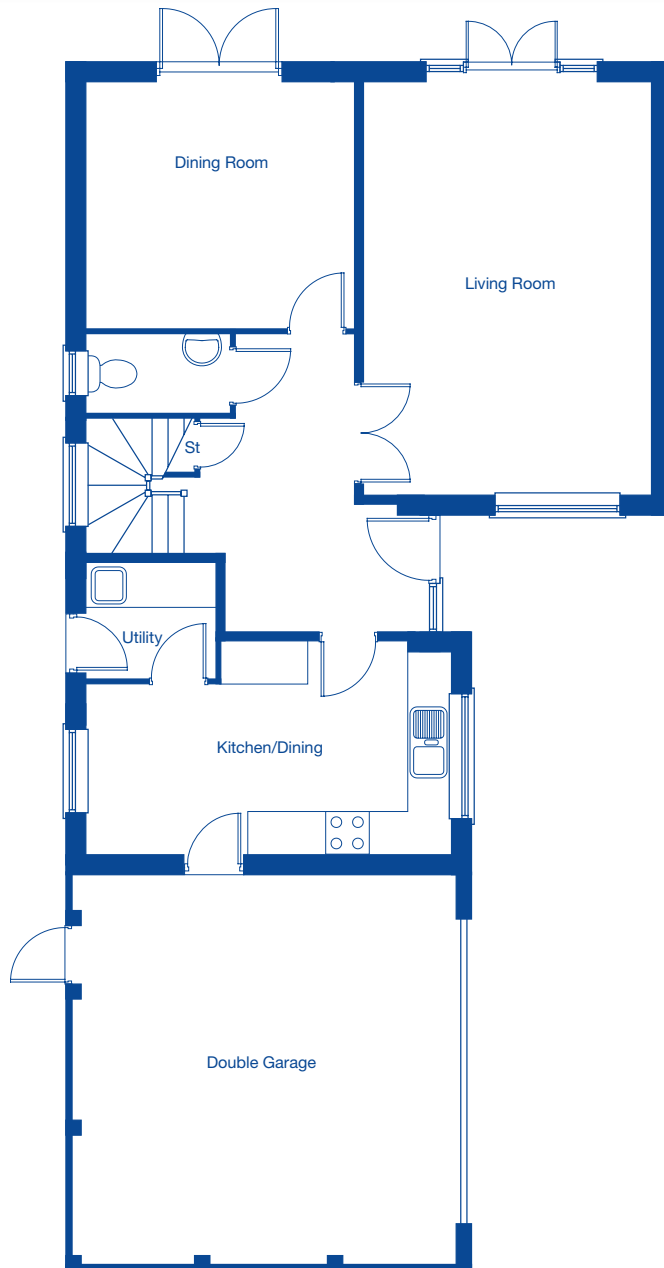

Ground Floor

Living Room	5.76m x 4.00m	18'11" x 13'1"
Kitchen/Dining	5.08m x 2.97m	16'8" x 9'9"
Dining Room	3.73m x 3.43m	12'3" x 11'3"
Double Garage	5.53m x 5.42m	18'2" x 17'9"

First Floor

Bedroom 1	5.08m x 4.12m	16'8" x 13'6"
Bedroom 2	4.21m x 2.96m	13'10" x 9'9"
Bedroom 3	4.21m x 2.70m	13'10" x 8'10"
Bedroom 4	3.59m x 2.65m	11'9" x 8'8"