

THE OSBORNE

2 BEDROOM COTTAGE

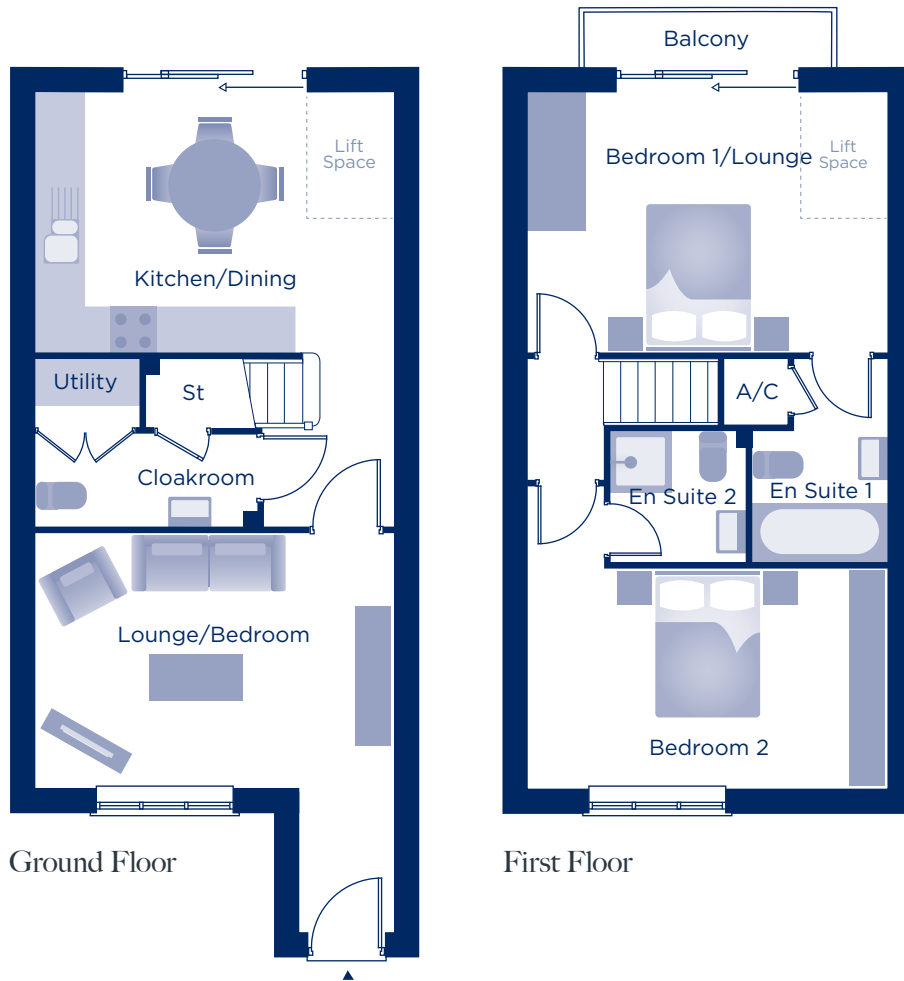

Ground Floor

| | | |
|----------------|---------------|----------------|
| Lounge/Bedroom | 4.57m x 3.26m | 15'0" x 10'8" |
| Kitchen/Dining | 4.57m x 3.33m | 15'0" x 10'11" |

First Floor

| | | |
|------------------|---------------|---------------|
| Bedroom 1/Lounge | 4.57m x 3.33m | 15'0" x 11'0" |
| En Suite 1 | 2.62m x 1.70m | 8'7" x 5'7" |
| Bedroom 2 | 4.57m x 2.81m | 15'0" x 9'2" |
| En Suite 2 | 1.75m x 1.68m | 5'9" x 5'6" |

These floor plans and suggested furniture layouts are for guidance and illustrative purposes only and do not form part of any contract. All room sizes are approximate to maximum dimensions and some plots may be subject to additional gable or bay windows. Please ask our Sales Advisor for details on specification and plot specific street scenes. Every effort has been taken to ensure these plans are as accurate as possible at time of printing. However, Jones Homes reserves the right to vary details as may be necessary and without notice.